

Hike #370

HIKE for 23 APRIL, 1997WILDWOOD PARK "SHADY JOHN" CHADY, HIKE LEADER

This may be a repeat hike for some, however many of the OTP Hiking and Debating Society said that they had not hiked it before. I have not prehiked these trails but have been assured by a friend that they are beautiful as well as challenging even though the elevation gain does not appear to be too great, about 800 to 1000 feet (guestimate). The planned hike itself, around the entire loop, will be about 6 miles (another guestimate). There are many opportunities for the hike to be shortened so it looks like Wildwood Park can satisfy the desires of many...from a stroll in the park with flower smelling opportunities to a climb/hike to/along the Mountclef Ridge.

To get to Wildwood Park go North from the 101 (Ventura Freeway) about 2 miles on Lynn Road. (Lynn Road is 2-1/4 miles West of the Hwy 23 Freeway in Thousand Oaks). Turn left (West) on Avenida Los Arboles (look for sign to Wildwood Park) and drive about 1 mile to the parking lot and the start of the hike.

We will start hiking at 9:30 AM. The hike will descend from the East end of the parking lot into the canyon and follow the Indian Creek Trail and the Wildwood Trail to Lizard Rock. From Lizard Rock we shall take Mesa Trail to Santa Rosa Trail to Mountclef Ridge and loop back to the parking lot. We can do the refreshments in the parking lot or return a short distance East on Los Arboles to a small park.

Y'all come now, hear?

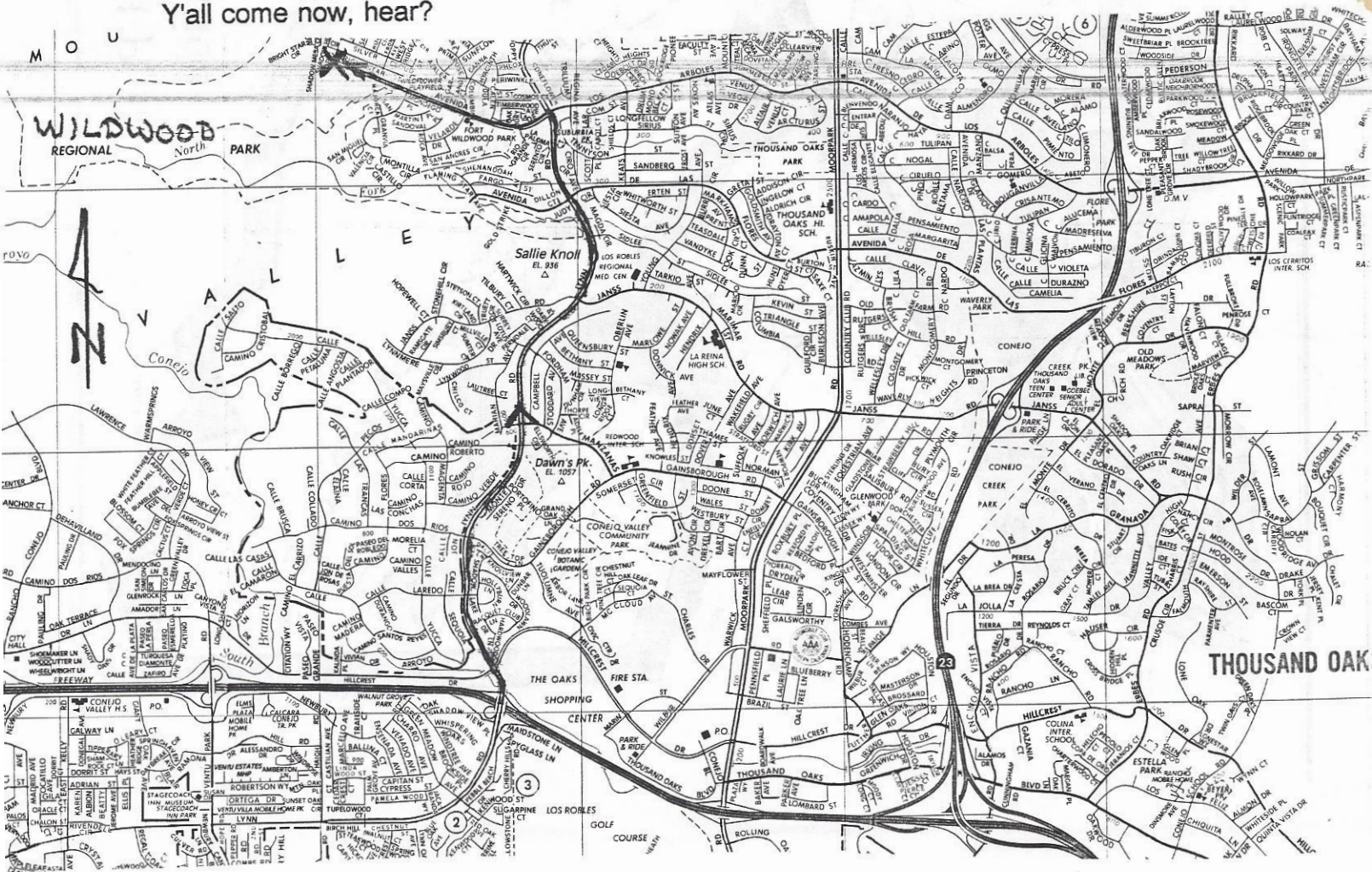

Wildwood Park Trail Guide

LEGEND

- DESIGNATED TRAIL
- PROPOSED TRAIL
- SERVICE ROAD
- ACCESS ROAD
- STREAM
- PARKING
- EXISTING RESIDENTIAL
- PICNIC AREA

1. LITTLE FALLS
2. SYCAMORE FLATS
3. OAK GROVE
4. WILDWOOD CANYON
5. SKUNK HOLLOW

N
NOT TO SCALE

